

SMA Connector Series (DC~27GHz)

Allwin technology SMA Connectors are 50Ω precision connectors. They are designed with excellent characteristics over the full frequency range up to 27GHz. No external filling epoxy hole on the housing to prevent signal leakage.

Specifications

Impedance: 50Ω
Frequency: DC-27GHz
VSWR:
DC-18GHz... 1.10:1 (max)
18GHz-27GHz...1.15:1 (max)
Contact Resistance: Center Contact≤3.0mΩ
Housing≤2.0mΩ
Insulation Resistance: ≥5000MΩ
Dielectric Withstanding Voltage: 1000V
Durability: 500 Cycles
Temperature Range: -55℃~+165℃

Material/Finishing

Housing: Stainless Steel SU303	Polished/Passivated
Center Contact: Beryllium Copper	Gold plated PER MIL-G-45204
Insulators: PTFE&PEI	

Interface: PER MIL-STD-348A

Interface Dimensions

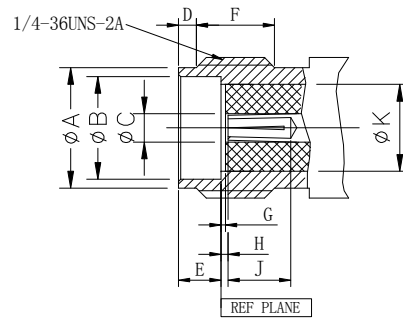
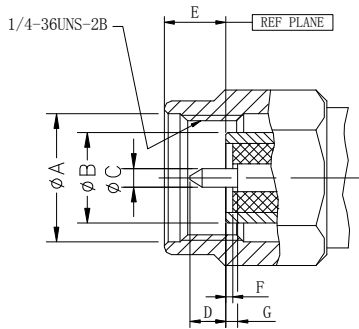

SMA Male				
	mm		Inch	
	Min	Max	Min	Max
A	6.48	6.73	0.255	0.265
B	4.52	4.59	0.1780	0.1808
C	0.90	0.93	0.0355	0.0365
D	2.03	2.29	0.080	0.090
E	2.59	3.35	0.102	0.132
F	0.00	0.05	0.000	0.002
G	0.00	0.08	0.000	0.003

SMA Female				
	mm		Inch	
	Min	Max	Min	Max
A	5.28	5.49	0.208	0.216
B	4.60	4.67	0.1810	0.1837
C	1.27	1.29	0.0500	0.0506
D	0.38	1.14	0.015	0.045
E	1.88	1.98	0.074	0.078
F	3.81	—	0.150	—
G	0.00	0.05	0.000	0.002
H	0.00	0.08	0.000	0.003
J	2.54	—	0.100	—
K	4.10	4.13	0.1615	0.1625

❖ SMA Replaceable Connectors

➤ Product Application

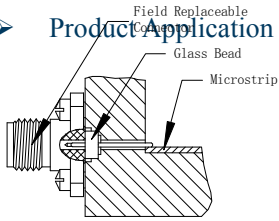

glass bead Transitions to Microstrip and Stripline Circuits in conjunction with replaceable flange connector

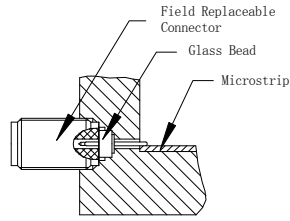

glass bead Transitions to Microstrip and Stripline Circuits in conjunction with replaceable screw thread connector

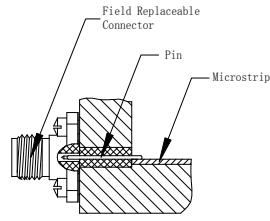

Launch Pin & Dielectric Transitions to Microstrip and Stripline Circuits
*refer to combination type connector

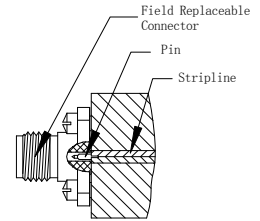

Pin/Tab Transitions to Microstrip and Stripline Circuits
*refer to combination type connector

➤ Glass Bead Commonly Used Size

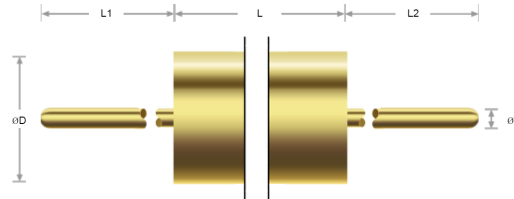

Commonly used size (recommend)					
d	0.23mm 0.009"	0.30mm 0.012"	0.38mm 0.015"	0.46mm 0.018"	0.51mm 0.020"
D	1.73mm 0.068"	1.93mm 0.076"	2.49mm 0.098"	2.79mm 0.110"	4.01mm 0.158"
L	1.40mm 0.055"	1.40mm 0.055"	1.57mm 0.062"	1.52mm 0.06"	1.52mm 0.06"
L1	A variety of sizes available				
L2	A variety of sizes available				

*Note: both ends of L1/L2 can insert into connector, depth less than 2mm

➤ Glass Bead Installation Dimension (FYI)

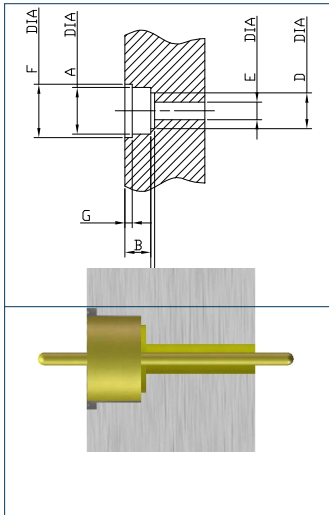

Pin diameter	0.23mm 0.009"	0.30mm 0.012"	0.38mm 0.015"	0.46mm 0.018"	0.51mm 0.020"
A	Glass bead dimension D&L				
B					
C	0.15-0.20mm 0.006-0.008"	0.06-0.09mm 0.0025-0.0035"	0.13-0.18mm 0.005-0.007"	0.18-0.23mm 0.007-0.009"	0.23-0.25mm 0.009-0.010"
D	0.77-0.82mm 0.0302-0.0322"	1.65-1.70mm 0.065-0.067"	1.98-2.03mm 0.078-0.080"	2.13-2.18mm 0.084-0.086"	3.15-3.20mm 0.124-0.126"
E	This is 50 ohms transmission line, In accordance with pin diameter conversion, E=pin diameter*2.3				
F	Solder capture slot, common dimension is F=A+1mm				
G	Solder capture slot, common dimension is 0.5mm				

*Note: C / D structure is optional if processing precision can not guarantee

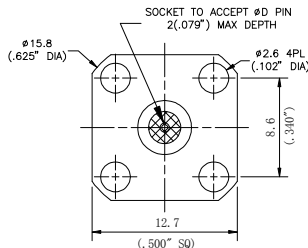
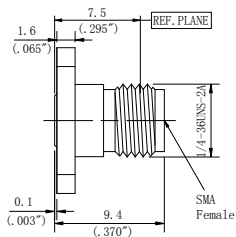
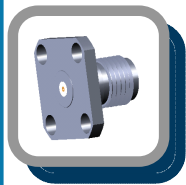

PN	Diameter
D550S09F01	0.23mm/0.009 "
D550S12F01	0.30mm/0.012 "
D550S15F01	0.38mm/0.015 "
D550S18F01	0.46mm/0.018 "
D550S20F01	0.51mm/0.020 "

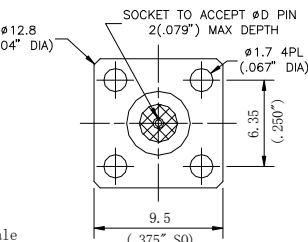
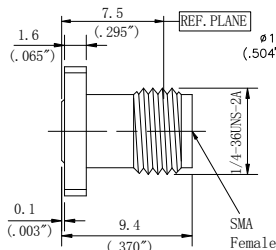

PN	Diameter
D550S09F02	0.23mm/0.009 "
D550S12F02	0.30mm/0.012 "
D550S15F02	0.38mm/0.015 "
D550S18F02	0.46mm/0.018 "
D550S20F02	0.51mm/0.020 "

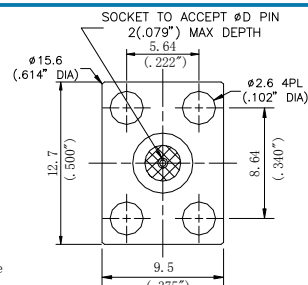
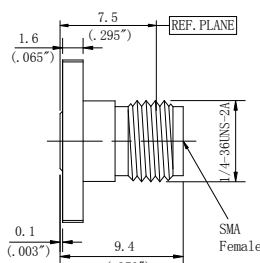

PN	Diameter
D550S09F03	0.23mm/0.009 "
D550S12F03	0.30mm/0.012 "
D550S15F03	0.38mm/0.015 "
D550S18F03	0.46mm/0.018 "
D550S20F03	0.51mm/0.020 "

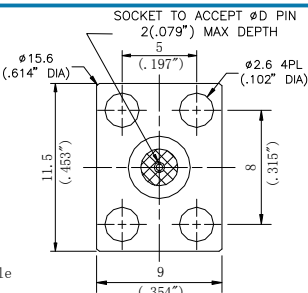
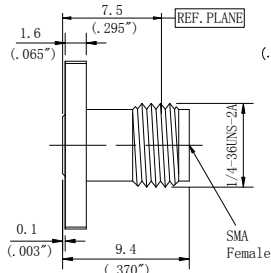

PN	Diameter
D550S09F13	0.23mm/0.009 "
D550S12F13	0.30mm/0.012 "
D550S15F13	0.38mm/0.015 "
D550S18F13	0.46mm/0.018 "
D550S20F13	0.51mm/0.020 "

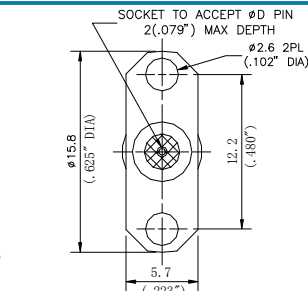
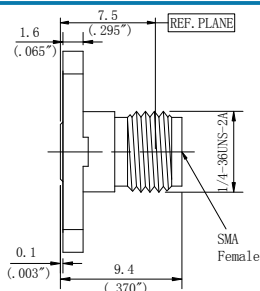

PN	Diameter
D550S09F04	0.23mm/0.009 "
D550S12F04	0.30mm/0.012 "
D550S15F04	0.38mm/0.015 "
D550S18F04	0.46mm/0.018 "
D550S20F04	0.51mm/0.020 "

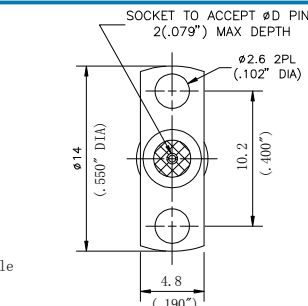
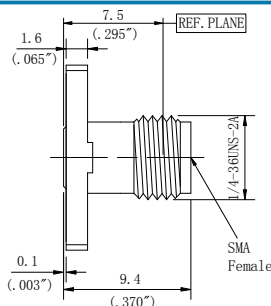

PN	Diameter
D550S09F05	0.23mm/0.009 "
D550S12F05	0.30mm/0.012 "
D550S15F05	0.38mm/0.015 "
D550S18F05	0.46mm/0.018 "
D550S20F05	0.51mm/0.020 "

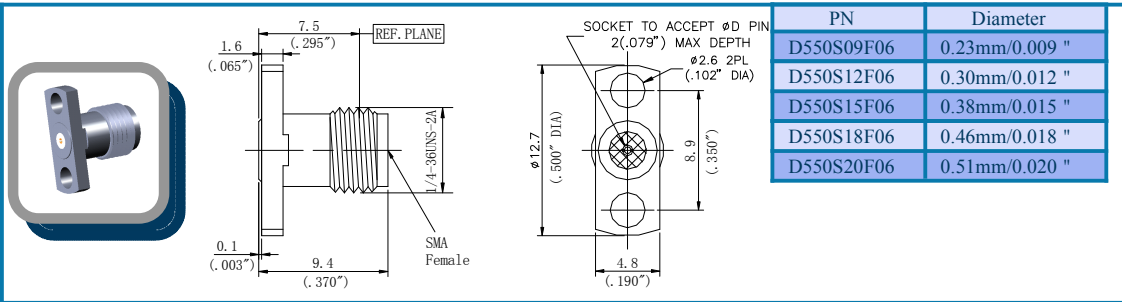

PN	Diameter
D550S09F06	0.23mm/0.009 "
D550S12F06	0.30mm/0.012 "
D550S15F06	0.38mm/0.015 "
D550S18F06	0.46mm/0.018 "
D550S20F06	0.51mm/0.020 "

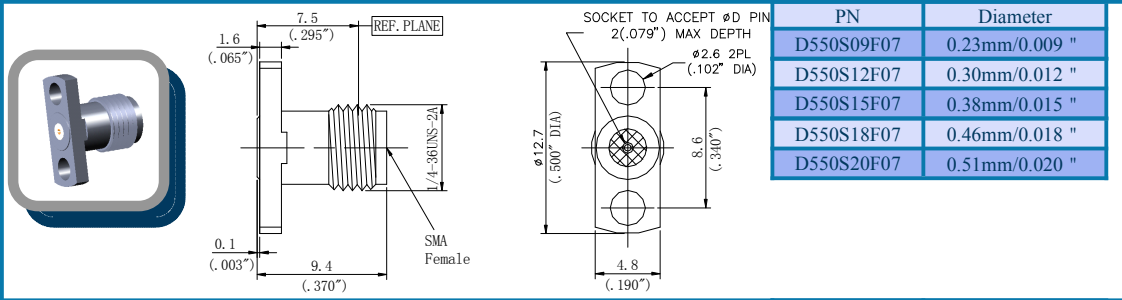

PN	Diameter
D550S09F07	0.23mm/0.009 "
D550S12F07	0.30mm/0.012 "
D550S15F07	0.38mm/0.015 "
D550S18F07	0.46mm/0.018 "
D550S20F07	0.51mm/0.020 "

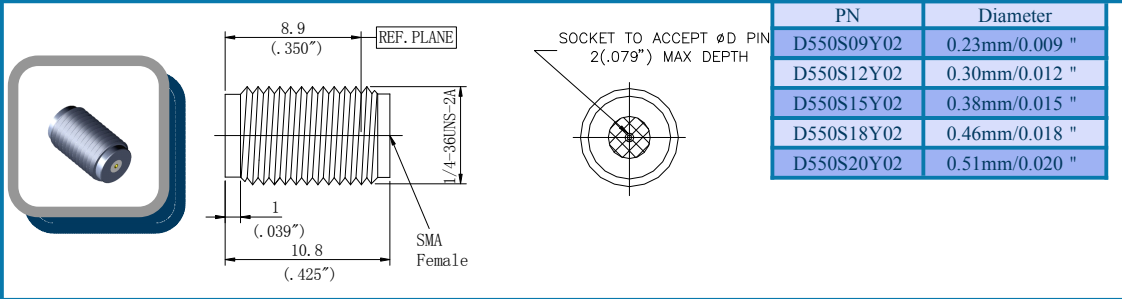

PN	Diameter
D550S09Y02	0.23mm/0.009 "
D550S12Y02	0.30mm/0.012 "
D550S15Y02	0.38mm/0.015 "
D550S18Y02	0.46mm/0.018 "
D550S20Y02	0.51mm/0.020 "

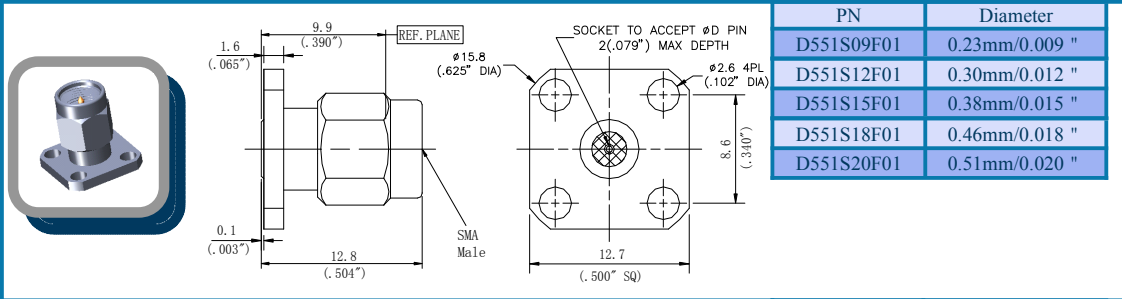

PN	Diameter
D551S09F01	0.23mm/0.009 "
D551S12F01	0.30mm/0.012 "
D551S15F01	0.38mm/0.015 "
D551S18F01	0.46mm/0.018 "
D551S20F01	0.51mm/0.020 "

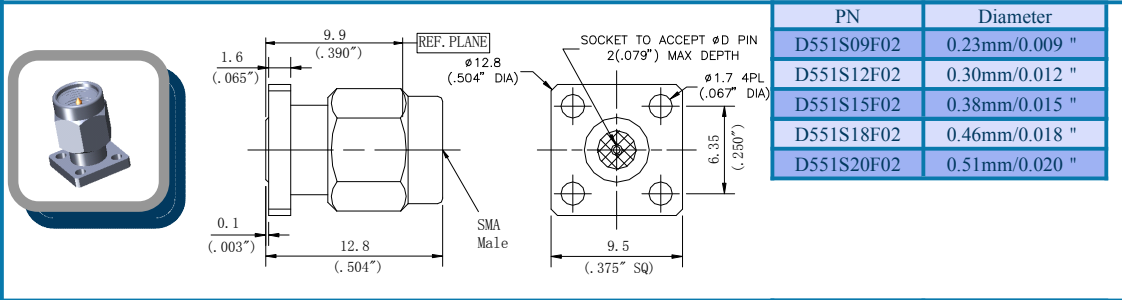

PN	Diameter
D551S09F02	0.23mm/0.009 "
D551S12F02	0.30mm/0.012 "
D551S15F02	0.38mm/0.015 "
D551S18F02	0.46mm/0.018 "
D551S20F02	0.51mm/0.020 "

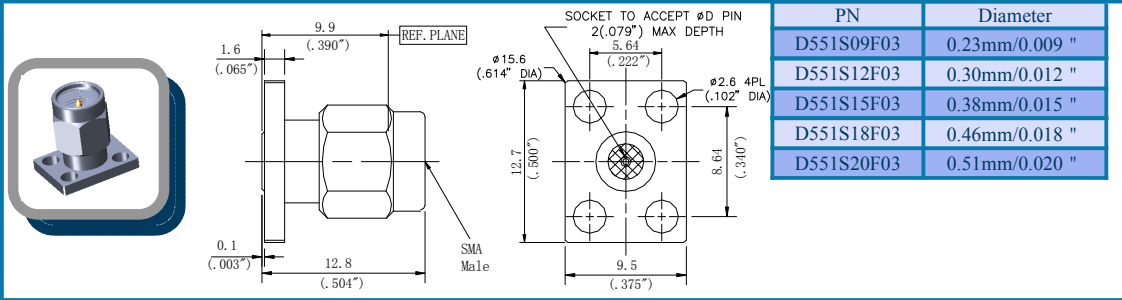

PN	Diameter
D551S09F03	0.23mm/0.009 "
D551S12F03	0.30mm/0.012 "
D551S15F03	0.38mm/0.015 "
D551S18F03	0.46mm/0.018 "
D551S20F03	0.51mm/0.020 "

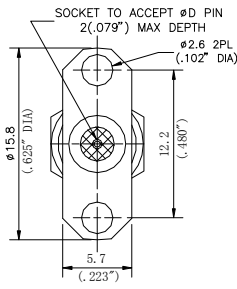
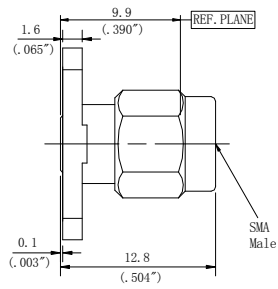

PN	Diameter
D551S09F04	0.23mm/0.009 "
D551S12F04	0.30mm/0.012 "
D551S15F04	0.38mm/0.015 "
D551S18F04	0.46mm/0.018 "
D551S20F04	0.51mm/0.020 "

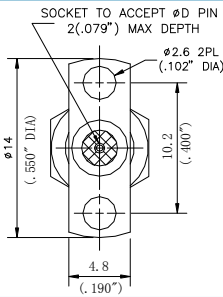
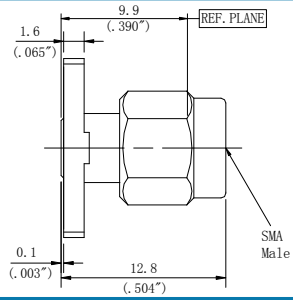

PN	Diameter
D551S09F05	0.23mm/0.009 "
D551S12F05	0.30mm/0.012 "
D551S15F05	0.38mm/0.015 "
D551S18F05	0.46mm/0.018 "
D551S20F05	0.51mm/0.020 "

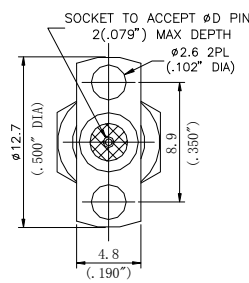
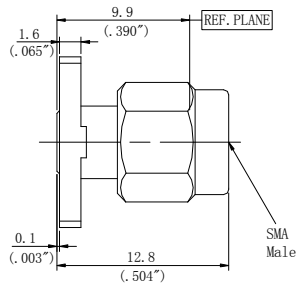

PN	Diameter
D551S09F06	0.23mm/0.009 "
D551S12F06	0.30mm/0.012 "
D551S15F06	0.38mm/0.015 "
D551S18F06	0.46mm/0.018 "
D551S20F06	0.51mm/0.020 "

❖ SMA Receptacle(Round Contact) Connectors

➤ Product Application

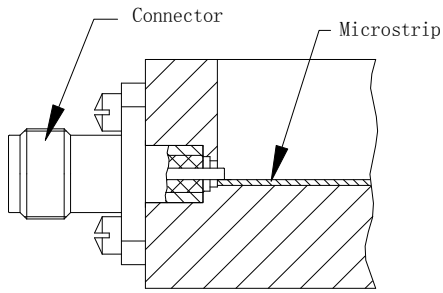

Project 1—SWR matching

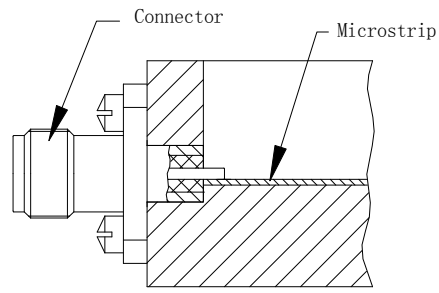

Project 2—through hole

➤ Installation Dimension (project 1—SWR matching structure, FYI)

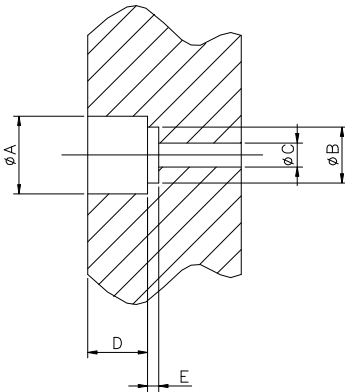

Connector PN	D550M0101F**	D550M0202F**
A	4.00-4.02mm 0.157-0.158"	4.00-4.02mm 0.157-0.158"
B	2.19-2.21mm 0.086-0.087"	1.23-1.25mm 0.048-0.049"
C	1.83-1.85mm 0.072-0.073"	0.86-0.88mm 0.034-0.035"
D	3.95-4.00mm 0.156-0.157"	2.95-3.00mm 0.116-0.118"
E	0.19-0.21mm 0.0075-0.0083"	0.09-0.11mm 0.0036-0.0044"

*Note: D should be shorter than metal contact ring. Make the front end of metal contact can be tightly stick on the internal surface to ensure better VSWR.

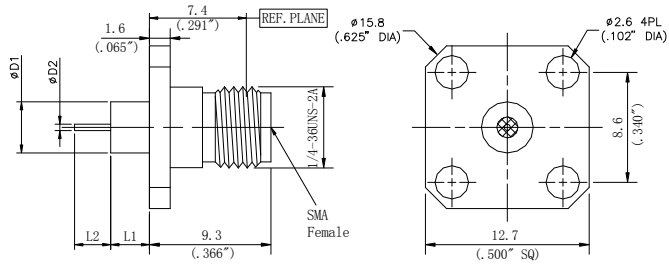
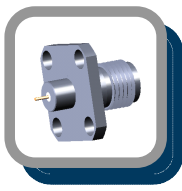

PN	D1	D2	L1	L2
D550M0101F01	4mm/0.158 "	0.8mm/0.031 "	4mm/0.158 "	2mm/0.079 "
D550M0202F01	4mm/0.158 "	0.38mm/0.015 "	3mm/0.118 "	2mm/0.079 "

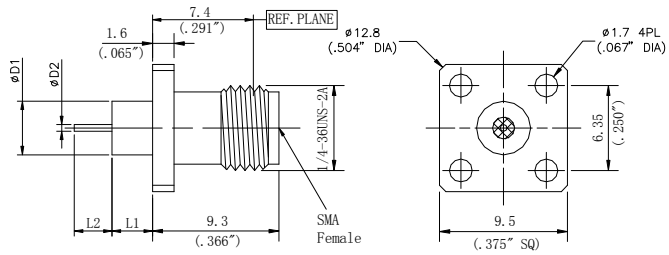
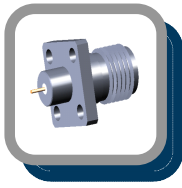

PN	D1	D2	L1	L2
D550M0101F02	4mm/0.158 "	0.8mm/0.031 "	4mm/0.158 "	2mm/0.079 "
D550M0202F02	4mm/0.158 "	0.38mm/0.015 "	3mm/0.118 "	2mm/0.079 "

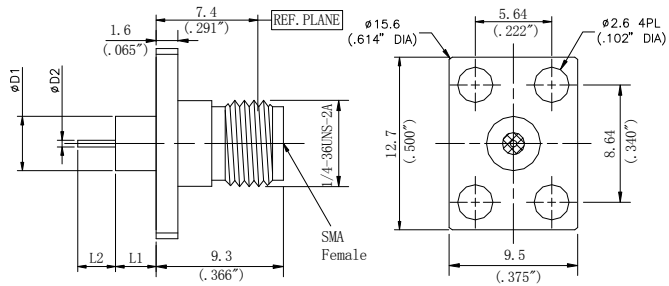
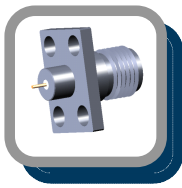

PN	D1	D2	L1	L2
D550M0101F03	4mm/0.158 "	0.8mm/0.031 "	4mm/0.158 "	2mm/0.079 "
D550M0202F03	4mm/0.158 "	0.38mm/0.015 "	3mm/0.118 "	2mm/0.079 "

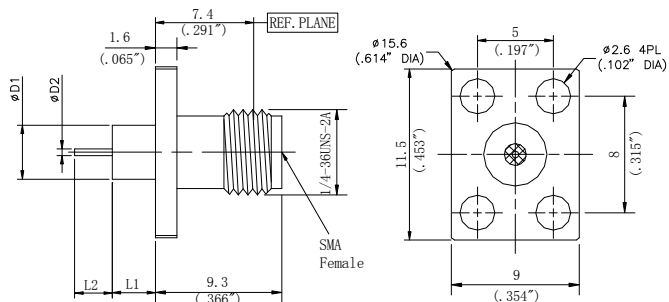
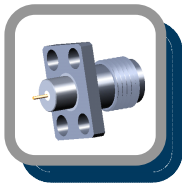

PN	D1	D2	L1	L2
D550M0101F13	4mm/0.158 "	0.8mm/0.031 "	4mm/0.158 "	2mm/0.079 "
D550M0202F13	4mm/0.158 "	0.38mm/0.015 "	3mm/0.118 "	2mm/0.079 "

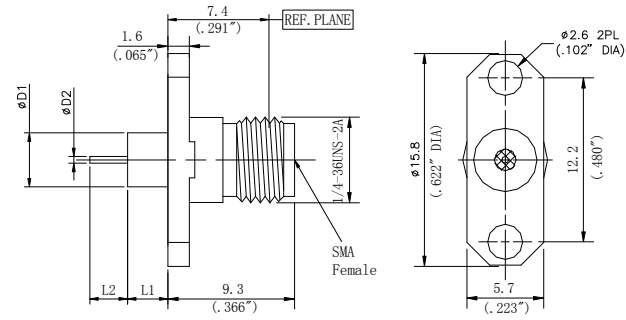
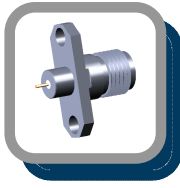

PN	D1	D2	L1	L2
D550M0101F04	4mm/0.158 "	0.8mm/0.031 "	4mm/0.158 "	2mm/0.079 "
D550M0202F04	4mm/0.158 "	0.38mm/0.015 "	3mm/0.118 "	2mm/0.079 "

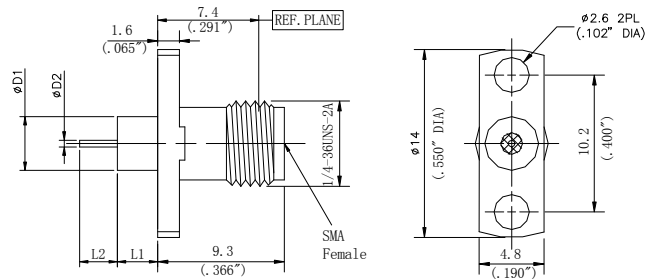

PN	D1	D2	L1	L2
D550M0101F05	4mm/0.158 "	0.8mm/0.031 "	4mm/0.158 "	2mm/0.079 "
D550M0202F05	4mm/0.158 "	0.38mm/0.015 "	3mm/0.118 "	2mm/0.079 "

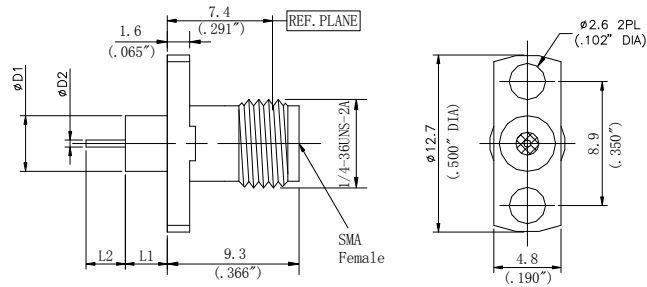

PN	D1	D2	L1	L2
D550M0101F06	4mm/0.158 "	0.8mm/0.031 "	4mm/0.158 "	2mm/0.079 "
D550M0202F06	4mm/0.158 "	0.38mm/0.015 "	3mm/0.118 "	2mm/0.079 "

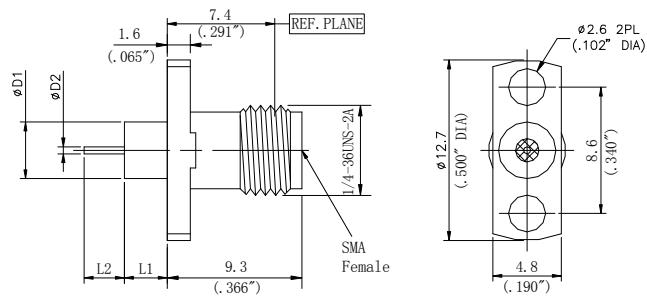
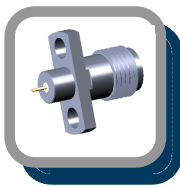

PN	D1	D2	L1	L2
D550M0101F07	4mm/0.158 "	0.8mm/0.031 "	4mm/0.158 "	2mm/0.079 "
D550M0202F07	4mm/0.158 "	0.38mm/0.015 "	3mm/0.118 "	2mm/0.079 "

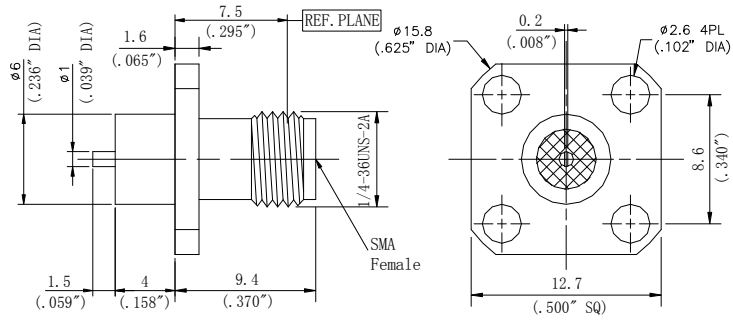

PN
D550M0313F01

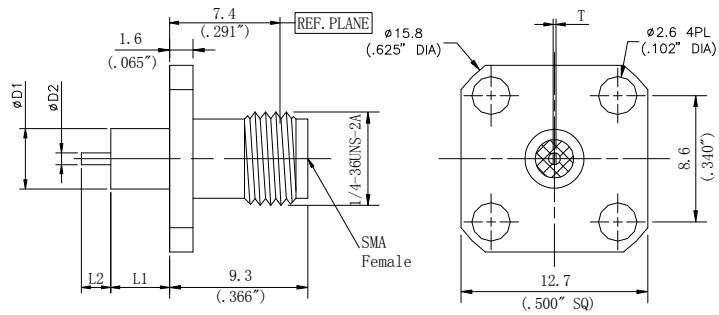
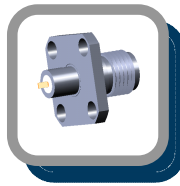

PN	D1	D2	L1	L2	T
D550M0112F01	4mm/0.158 "	0.8mm/0.031 "	4mm/0.158 "	1.5mm/0.06 "	0.2mm/0.008"

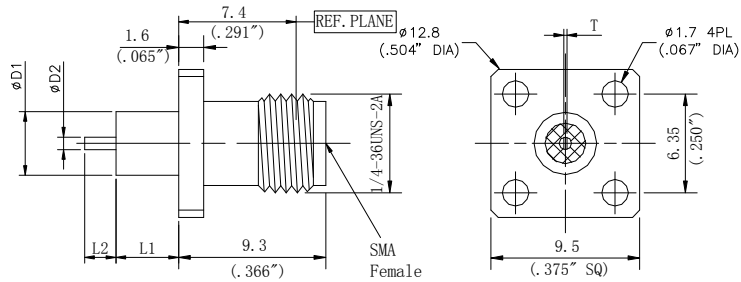
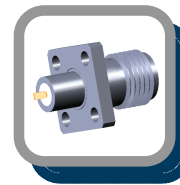

PN	D1	D2	L1	L2	T
D550M0112F02	4mm/0.158 "	0.8mm/0.031 "	4mm/0.158 "	1.5mm/0.06 "	0.2mm/0.008"

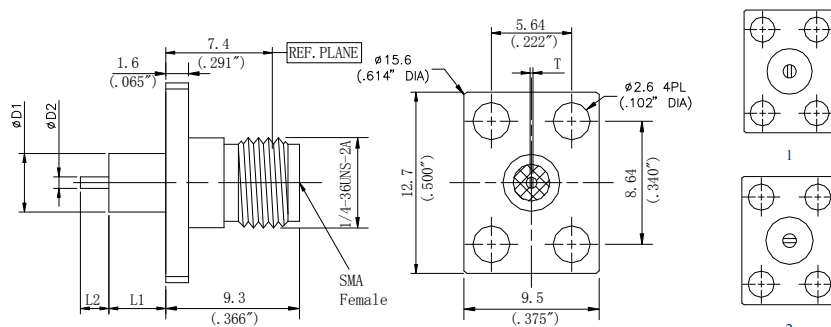
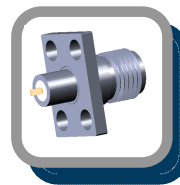

PN	D1	D2	L1	L2	T	drawing
D550M0112F03	4mm/0.158 "	0.8mm/0.031 "	4mm/0.158 "	1.5mm/0.06 "	0.2mm/0.008"	1
D550M0112F03C	4mm/0.158 "	0.8mm/0.031 "	4mm/0.158 "	1.5mm/0.06 "	0.2mm/0.008"	2

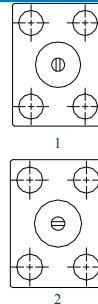
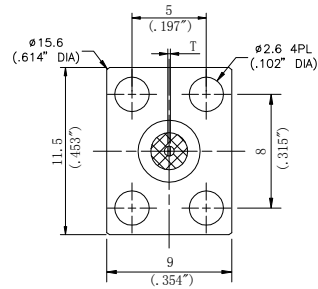
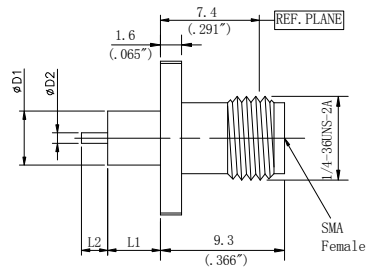

PN	D1	D2	L1	L2	T	drawing
D550M0112F13	4mm/0.158 "	0.8mm/0.031 "	4mm/0.158 "	1.5mm/0.06 "	0.2mm/0.008"	1
D550M0112F13C	4mm/0.158 "	0.8mm/0.031 "	4mm/0.158 "	1.5mm/0.06 "	0.2mm/0.008"	2

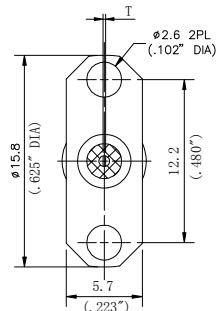
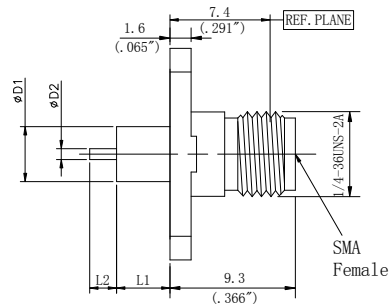

PN	D1	D2	L1	L2	T	drawing
D550M0112F04	4mm/0.158 "	0.8mm/0.031 "	4mm/0.158 "	1.5mm/0.06 "	0.2mm/0.008"	1
D550M0112F04C	4mm/0.158 "	0.8mm/0.031 "	4mm/0.158 "	1.5mm/0.06 "	0.2mm/0.008"	2

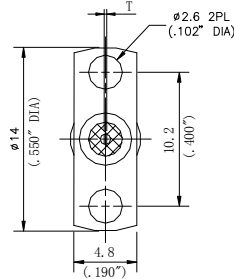
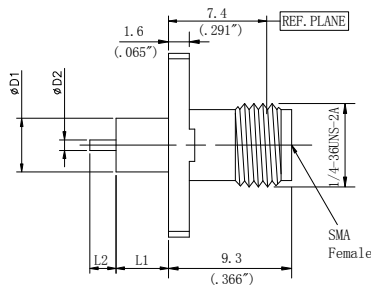
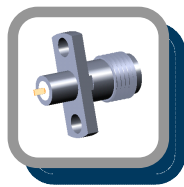

PN	D1	D2	L1	L2	T	drawing
D550M0112F05	4mm/0.158 "	0.8mm/0.031 "	4mm/0.158 "	1.5mm/0.06 "	0.2mm/0.008"	1
D550M0112F05C	4mm/0.158 "	0.8mm/0.031 "	4mm/0.158 "	1.5mm/0.06 "	0.2mm/0.008"	2

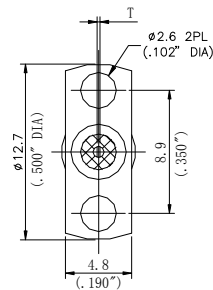
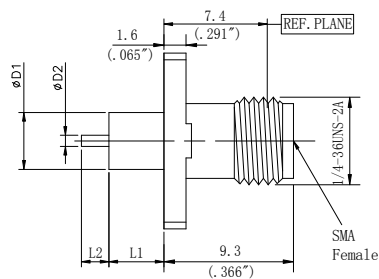

PN	D1	D2	L1	L2	T	drawing
D550M0112F06	4mm/0.158 "	0.8mm/0.031 "	4mm/0.158 "	1.5mm/0.06 "	0.2mm/0.008"	1
D550M0112F06C	4mm/0.158 "	0.8mm/0.031 "	4mm/0.158 "	1.5mm/0.06 "	0.2mm/0.008"	2

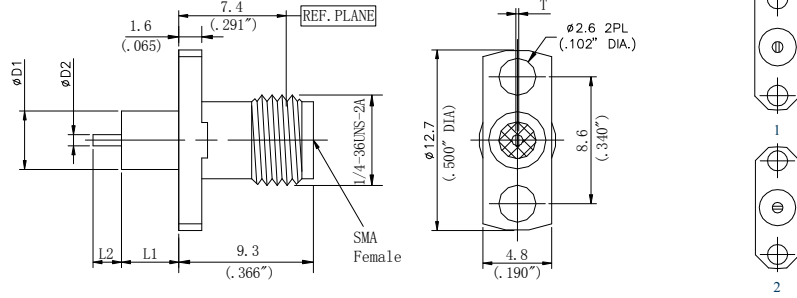

PN	D1	D2	L1	L2	T	drawing
D550M0112F07	4mm/0.158 "	0.8mm/0.031 "	4mm/0.158 "	1.5mm/0.06 "	0.2mm/0.008"	1
D550M0112F07C	4mm/0.158 "	0.8mm/0.031 "	4mm/0.158 "	1.5mm/0.06 "	0.2mm/0.008"	2

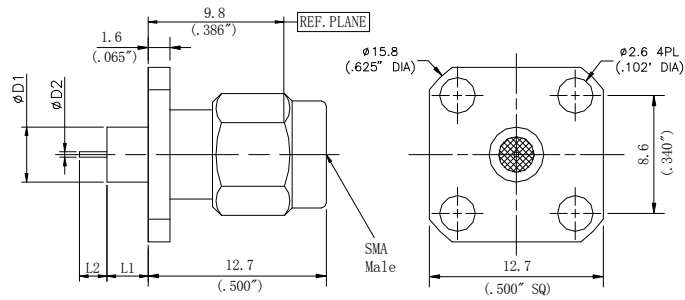
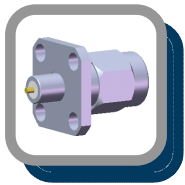

PN	D1	D2	L1	L2
D551M0202F01	4mm/0.158 "	0.38mm/0.015 "	3mm/0.118 "	2mm/0.079 "

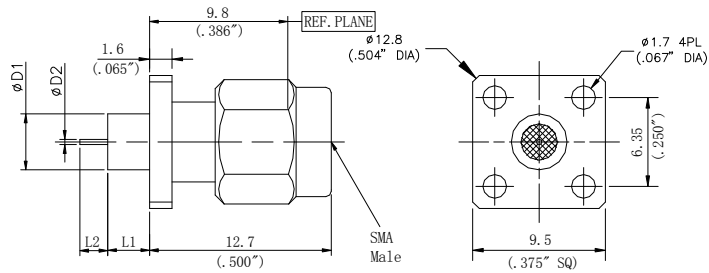

PN	D1	D2	L1	L2
D551M0202F02	4mm/0.158 "	0.38mm/0.015 "	3mm/0.118 "	2mm/0.079 "

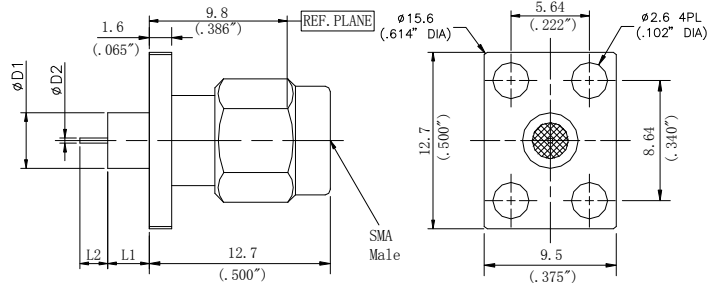
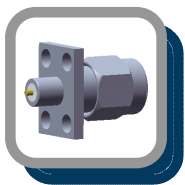

PN	D1	D2	L1	L2
D551M0202F03	4mm/0.158 "	0.38mm/0.015 "	3mm/0.118 "	2mm/0.079 "

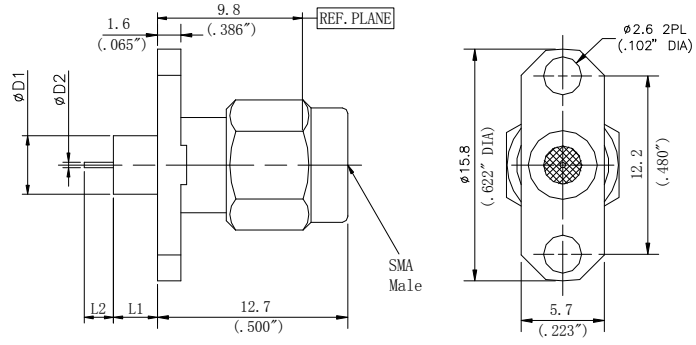
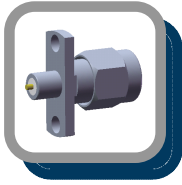

PN	D1	D2	L1	L2
D551M0202F04	4mm/0.158 "	0.38mm/0.015 "	3mm/0.118 "	2mm/0.079 "

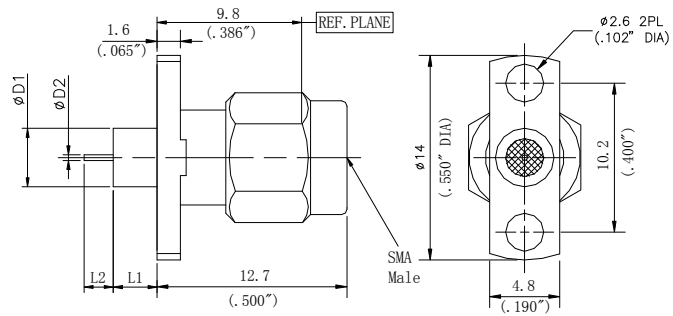
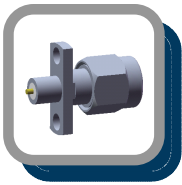

PN	D1	D2	L1	L2
D551M0202F05	4mm/0.158 "	0.38mm/0.015 "	3mm/0.118 "	2mm/0.079 "

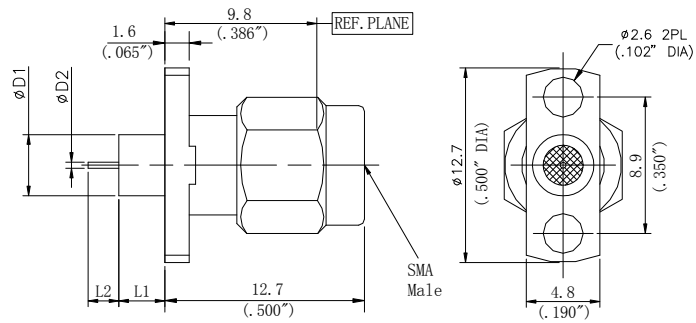

PN	D1	D2	L1	L2
D551M0202F06	4mm/0.158 "	0.38mm/0.015 "	3mm/0.118 "	2mm/0.079 "

❖ SMA Receptacle(Exposed Teflon) Connectors

➤ Product Application

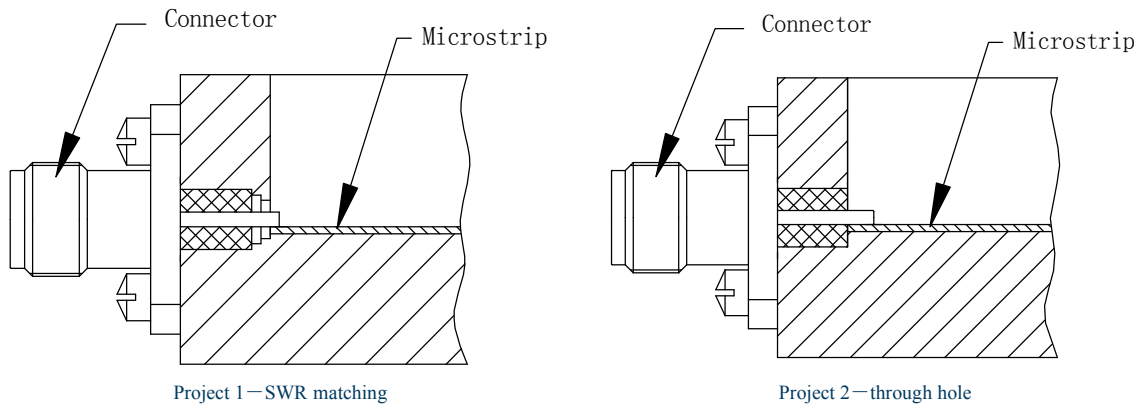

➤ Installation Dimension (project 1—SWR matching structure, FYI)

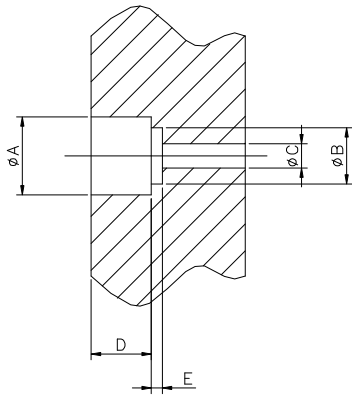

Connector PN	D550P0103F**	D550P0204F**	D550P0304F**
A	2.20-2.22mm 0.0866-0.0874"	3.90-3.92mm 0.1535-0.1543"	2.10-2.12mm 0.0827-0.0835"
B	0.68-0.70mm 0.0268-0.0276"	3.19-3.21mm 0.1256-0.1264"	1.81-1.83mm 0.0713-0.0721"
C	1.59-1.61mm 0.0626-0.0634"	1.46-1.48mm 0.0575-0.0583"	1.46-1.48mm 0.0575-0.0583"
D	3.20-3.22mm 0.126-0.127"	15.00-15.02mm 0.590-0.0591"	15.00-15.02mm 0.590-0.0591"
E	0.24-0.26mm 0.0095-0.0103"	0.38-0.40mm 0.0150-0.0158"	0.14-0.16mm 0.0056-0.0063"

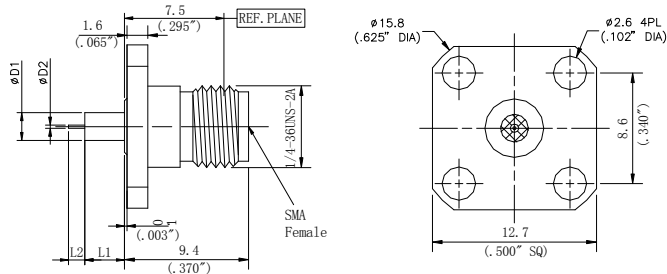
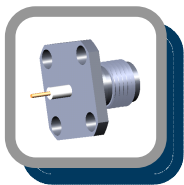

PN	D1	D2	L1	L2
D550P0103F01	2.2mm/0.087 "	0.30mm/0.012 "	3.2mm/0.126 "	1.27mm/0.05 "
D550P0204F01	3.9mm/0.154 "	0.64mm/0.025 "	15mm/0.59 "	3mm/0.118 "
D550P0304F01	2.1mm/0.083 "	0.64mm/0.025 "	15mm/0.59 "	3mm/0.118 "

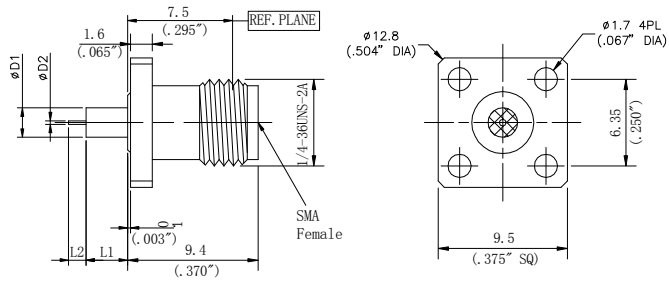
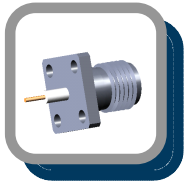

PN	D1	D2	L1	L2
D550P0103F02	2.2mm/0.087 "	0.30mm/0.012 "	3.2mm/0.126 "	1.27mm/0.05 "
D550P0304F02	2.1mm/0.083 "	0.64mm/0.025 "	15mm/0.59 "	3mm/0.118 "

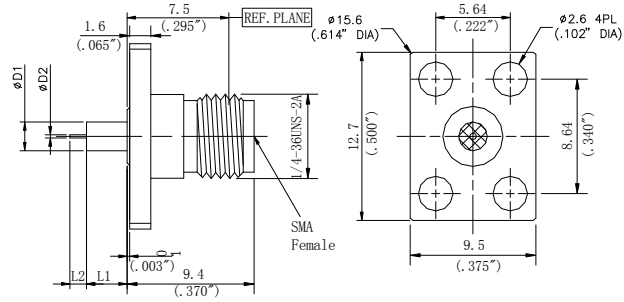
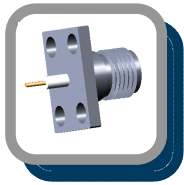

PN	D1	D2	L1	L2
D550P0103F03	2.2mm/0.087 "	0.30mm/0.012 "	3.2mm/0.126 "	1.27mm/0.05 "
D550P0304F03	2.1mm/0.083 "	0.64mm/0.025 "	15mm/0.59 "	3mm/0.118 "

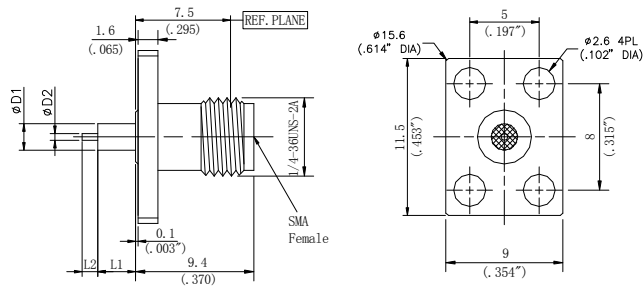
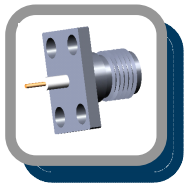

PN	D1	D2	L1	L2
D550P0103F13	2.2mm/0.087 "	0.30mm/0.012 "	3.2mm/0.126 "	1.27mm/0.05 "
D550P0304F13	2.1mm/0.083 "	0.64mm/0.025 "	15mm/0.59 "	3mm/0.118 "

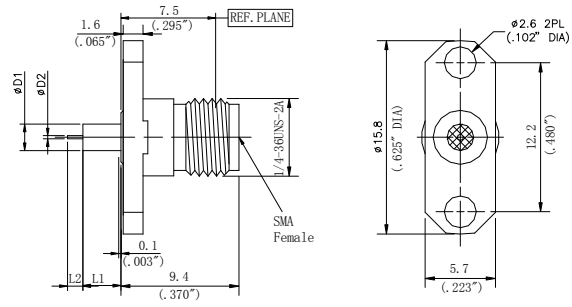

PN	D1	D2	L1	L2
D550P0103F04	2.2mm/0.087 "	0.30mm/0.012 "	3.2mm/0.126 "	1.27mm/0.05 "
D550P0204F04	3.9mm/0.154 "	0.64mm/0.025 "	15mm/0.59 "	3mm/0.118 "
D550P0304F04	2.1mm/0.083 "	0.64mm/0.025 "	15mm/0.59 "	3mm/0.118 "

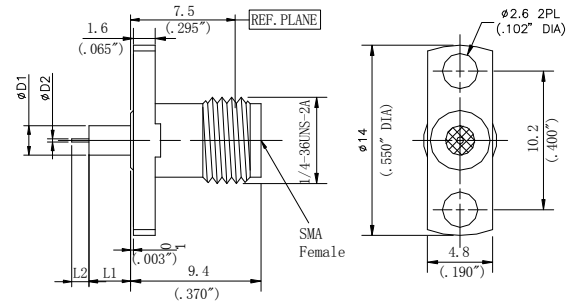

PN	D1	D2	L1	L2
D550P0103F05	2.2mm/0.087 "	0.30mm/0.012 "	3.2mm/0.126 "	1.27mm/0.05 "
D550P0304F05	2.1mm/0.083 "	0.64mm/0.025 "	15mm/0.59 "	3mm/0.118 "

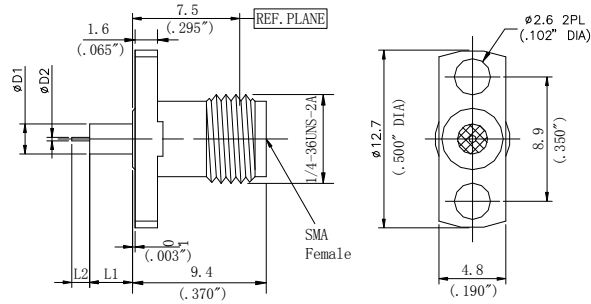

PN	D1	D2	L1	L2
D550P0103F06	2.2mm/0.087 "	0.30mm/0.012 "	3.2mm/0.126 "	1.27mm/0.05 "
D550P0304F06	2.1mm/0.083 "	0.64mm/0.025 "	15mm/0.59 "	3mm/0.118 "

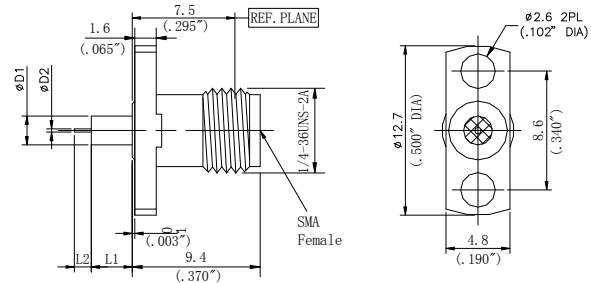

PN	D1	D2	L1	L2
D550P0103F07	2.2mm/0.087 "	0.30mm/0.012 "	3.2mm/0.126 "	1.27mm/0.05 "
D550P0304F07	2.1mm/0.083 "	0.64mm/0.025 "	15mm/0.59 "	3mm/0.118 "

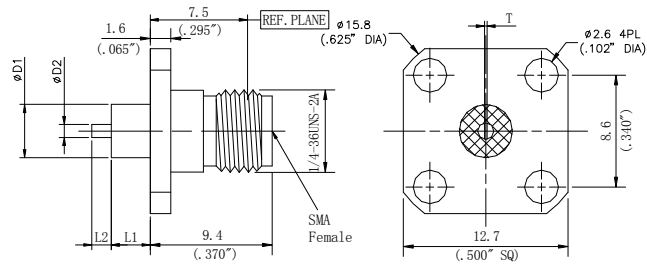
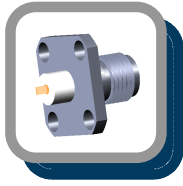

PN	D1	D2	L1	L2	T
D550P0713F01	4.1mm/0.162 "	1mm/0.04 "	4mm/0.158 "	1.5mm/0.06 "	0.2mm/0.008 "
D550P0813F01	4.1mm/0.162 "	1mm/0.04 "	3mm/0.118 "	1.5mm/0.06 "	0.2mm/0.008 "

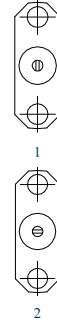
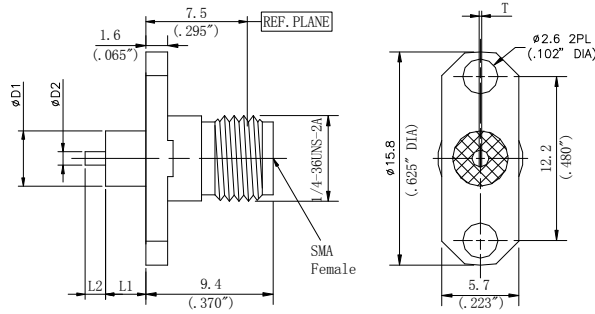

PN	D1	D2	L1	L2	T	drawing
D550P0713F04	4.1mm/0.162 "	1mm/0.04 "	4mm/0.158 "	1.5mm/0.06 "	0.2mm/0.008 "	1
D550P0713F04C	4.1mm/0.162 "	1mm/0.04 "	4mm/0.158 "	1.5mm/0.06 "	0.2mm/0.008 "	2
D550P0813F04	4.1mm/0.162 "	1mm/0.04 "	3mm/0.118 "	1.5mm/0.06 "	0.2mm/0.008 "	1
D550P0813F04C	4.1mm/0.162 "	1mm/0.04 "	3mm/0.118 "	1.5mm/0.06 "	0.2mm/0.008 "	2

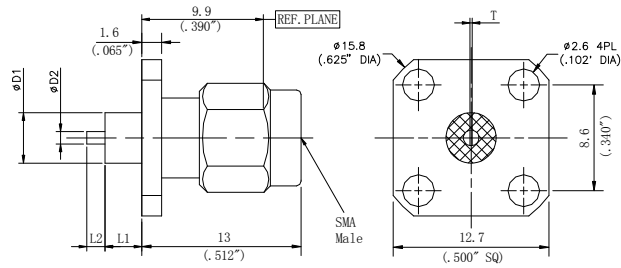
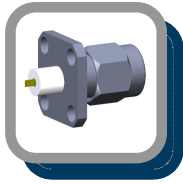

PN	D1	D2	L1	L2	T
D551P0713F01	4.1mm/0.162 "	1mm/0.04 "	4mm/0.158 "	1.5mm/0.06 "	0.2mm/0.008 "

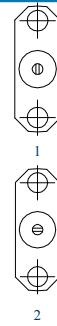
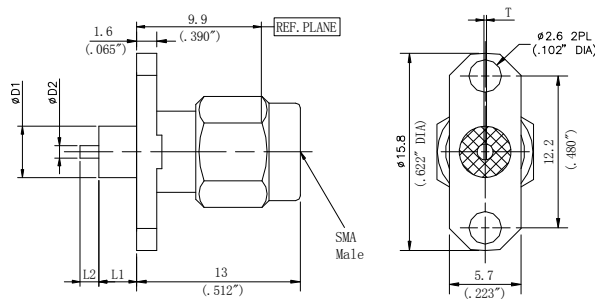
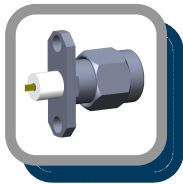

PN	D1	D2	L1	L2	T	drawing
D551P0713F04	4.1mm/0.162 "	1mm/0.04 "	4mm/0.158 "	1.5mm/0.06 "	0.2mm/0.008 "	1
D551P0713F04C	4.1mm/0.162 "	1mm/0.04 "	4mm/0.158 "	1.5mm/0.06 "	0.2mm/0.008 "	2

❖ SMA Receptacle(Blunt Post Contact)

➤ Product Application

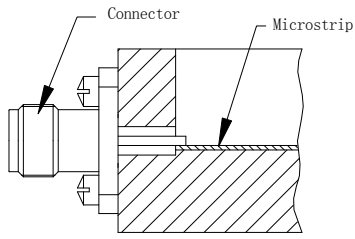

Project 1—stripline

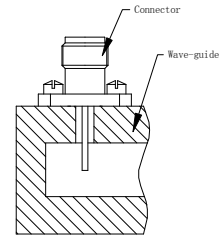

Project 2-waveguide-coaxial

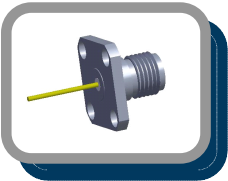

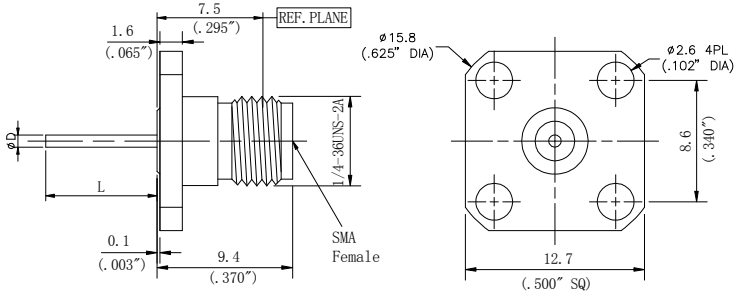

PN	D	L
D550D25F01-709	0.64mm/0.025 "	18mm/0.71 "
D550D34F01-1024	0.87mm/0.034 "	26mm/1.024 "
D550D34F01-430	0.87mm/0.034 "	10.92mm/0.430 "

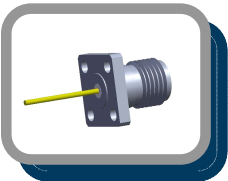

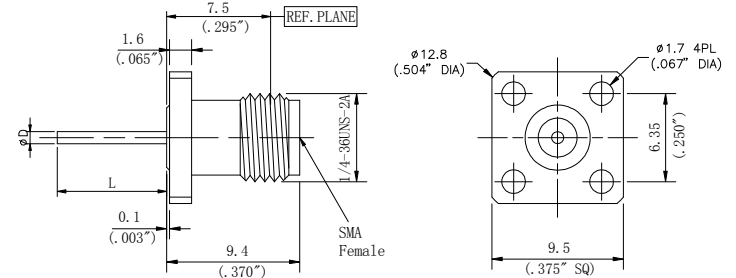

PN	D	L
D550D25F02-709	0.64mm/0.025 "	18mm/0.709 "
D550D34F02-1024	0.87mm/0.034 "	26mm/1.024 "
D550D34F02-430	0.87mm/0.034 "	10.92mm/0.430 "

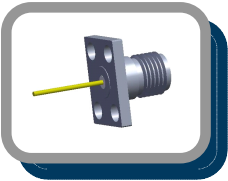

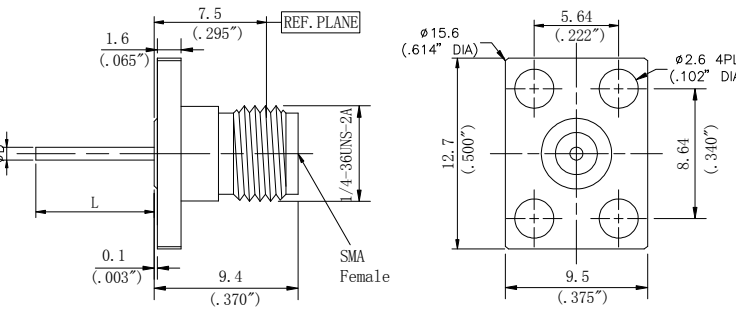

PN	D	L
D550D25F03-709	0.64mm/0.025 "	18mm/0.709 "
D550D34F03-1024	0.87mm/0.034 "	26mm/1.024 "
D550D34F03-430	0.87mm/0.034 "	10.92mm/0.430 "

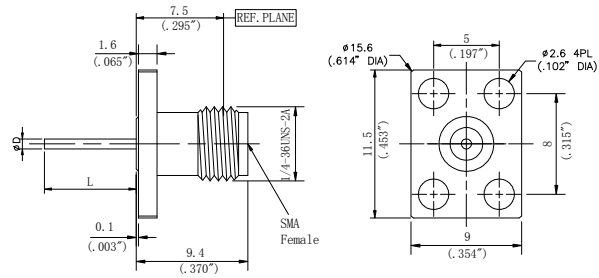
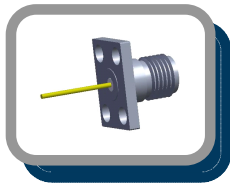

PN	D	L
D550D25F13-709	0.64mm/0.025 "	18mm/0.709 "
D550D34F13-1024	0.87mm/0.034 "	26mm/1.024 "
D550D34F13-430	0.87mm/0.034 "	10.92mm/0.430 "

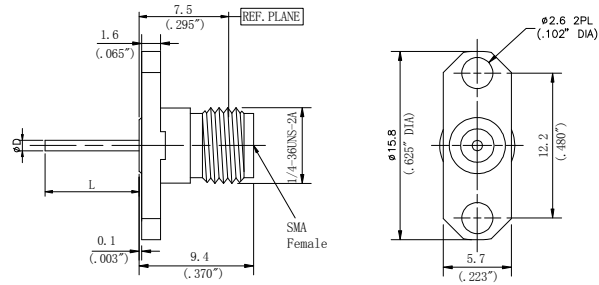
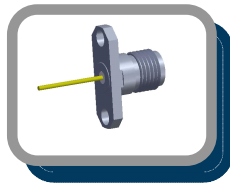

PN	D	L
D550D25F04-709	0.64mm/0.025 "	18mm/0.709 "
D550D34F04-1024	0.87mm/0.034 "	26mm/1.024 "
D550D34F04-430	0.87mm/0.034 "	10.92mm/0.430 "

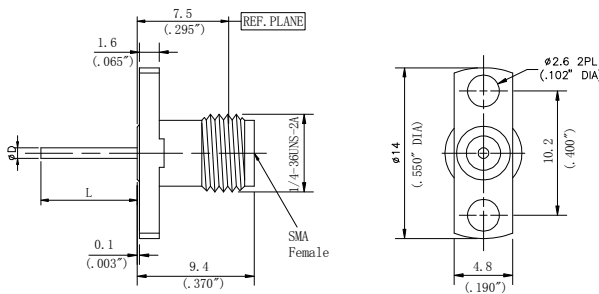

PN	D	L
D550D25F05-709	0.64mm/0.025 "	18mm/0.709 "
D550D34F05-1024	0.87mm/0.034 "	26mm/1.024 "
D550D34F05-430	0.87mm/0.034 "	10.92mm/0.430 "

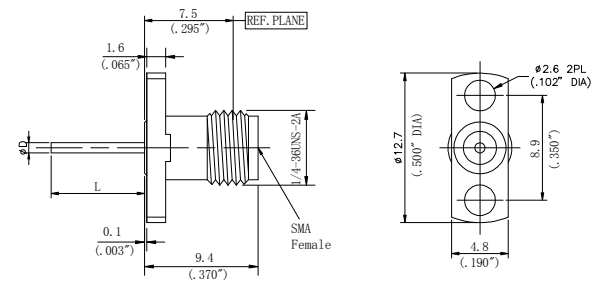

PN	D	L
D550D25F06-709	0.64mm/0.025 "	18mm/0.709 "
D550D34F06-1024	0.87mm/0.034 "	26mm/1.024 "
D550D34F06-430	0.87mm/0.034 "	10.92mm/0.430 "

❖ SMA Receptacle (Tab Contact) Connectors

➤ Product Application

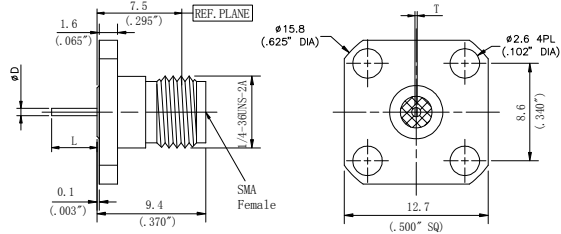
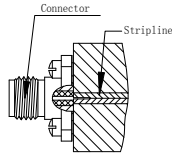

PN	D	L	T
D550T11F01	0.65mm/0.026 "	4mm/0.158 "	0.2mm/0.008 "
D550T14F01	1.27mm/0.050 "	1.27mm/0.050 "	0.15mm/0.006 "

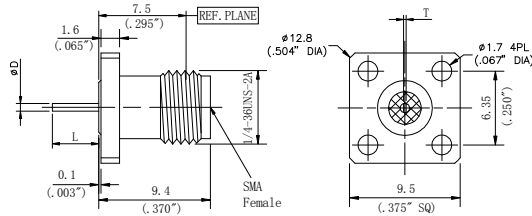
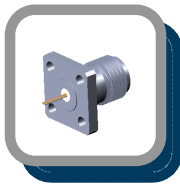

PN	D	L	T
D550T11F02	0.65mm/0.026 "	4mm/0.158 "	0.2mm/0.008 "
D550T14F02	1.27mm/0.050 "	1.27mm/0.050 "	0.15mm/0.006 "

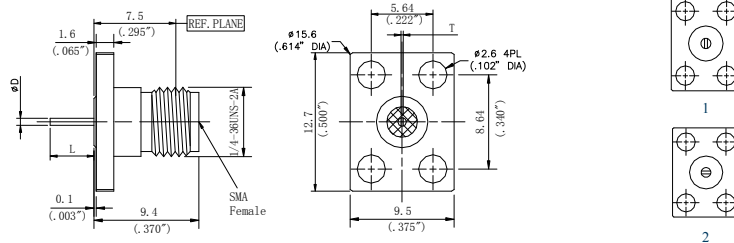
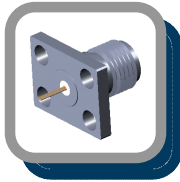

PN	D	L	T	Drawing
D550T11F03	0.65mm/0.026 "	4mm/0.158 "	0.2mm/0.008 "	1
D550T11F03C	0.65mm/0.026 "	4mm/0.158 "	0.2mm/0.008 "	2
D550T14F03	1.27mm/0.050 "	1.27mm/0.050 "	0.15mm/0.006 "	1
D550T14F03C	1.27mm/0.050 "	1.27mm/0.050 "	0.15mm/0.006 "	2

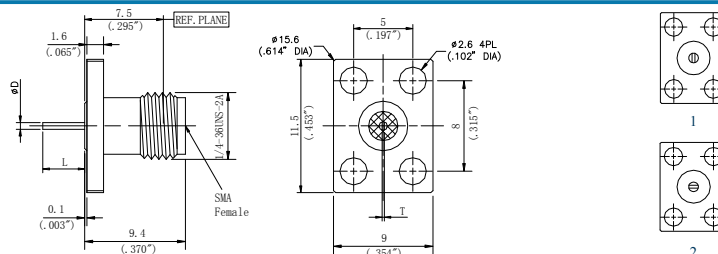
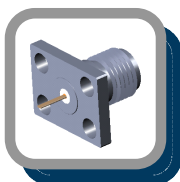

PN	D	L	T	Drawing
D550T11F13	0.65mm/0.026 "	4mm/0.158 "	0.2mm/0.008 "	1
D550T11F13C	0.65mm/0.026 "	4mm/0.158 "	0.2mm/0.008 "	2
D550T14F13	1.27mm/0.050 "	1.27mm/0.050 "	0.15mm/0.006 "	1
D550T14F13C	1.27mm/0.050 "	1.27mm/0.050 "	0.15mm/0.006 "	2

❖ SMA PCB Receptacles Connectors

➤ Product Application

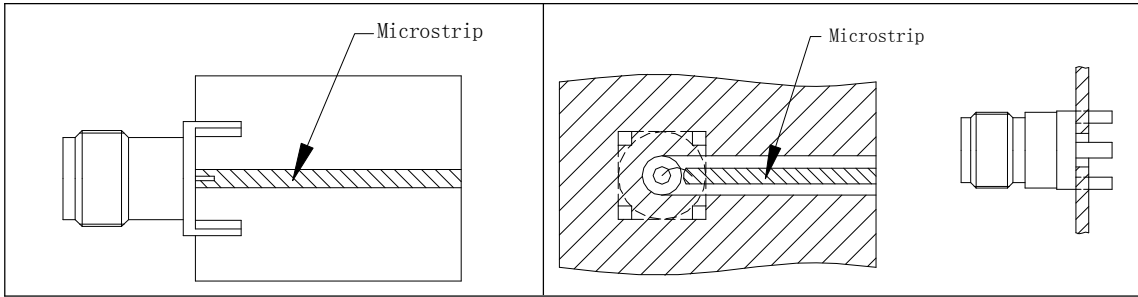

Project 1- Edge welding

Project 2-Vertical welding

assembly diagram

PN
D550B51H01-118

PN	D	L	PCB Board Thickness
D550B12E01-023	1.93mm/0.076 "	0.6mm/0.023 "	1.78mm/0.070 "
D550B12E02-023	0.76mm/0.030 "	0.6mm/0.023 "	0.61mm/0.024 "
D550B12E03-023	1.02mm/0.040 "	0.6mm/0.023 "	0.87mm/0.034 "
D550B12E01-048	1.93mm/0.076 "	1.22mm/0.048 "	1.78mm/0.070 "
D550B12E02-048	0.76mm/0.030 "	1.22mm/0.048 "	0.61mm/0.024 "
D550B12E03-048	1.02mm/0.040 "	1.22mm/0.048 "	0.87mm/0.034 "

✧ SMA Stripline Receptacles Connectors

